

BASIC HELP POWERPOINT TEMPLATE

By : Nyiltemp

BASIC HELP

Hi There,

Thanks for downloading our item. Here some basic instruction to us this item.

1. How To Change Image

- Go to Image Selection
- Afther that click the area > Double click image icon and choose file from your library. (You can drag it also!)

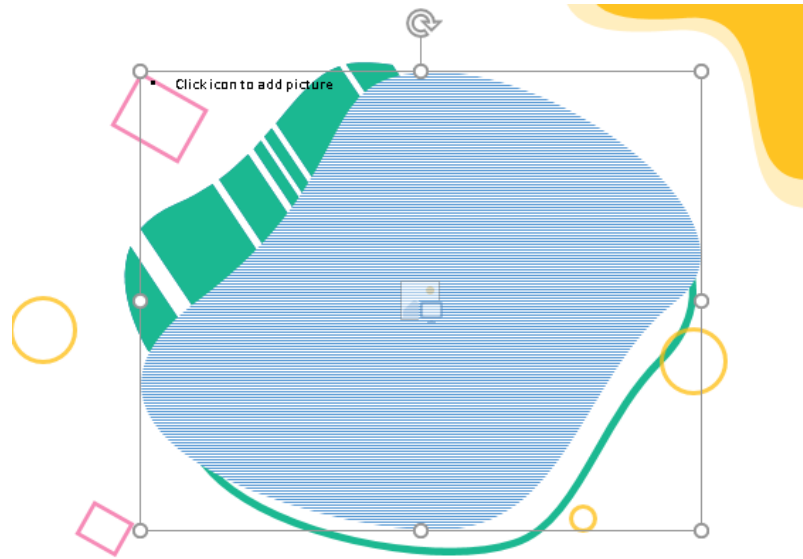

2. How To Change The Colors

- Go to area that you need to change the
- After that Click Format Shape > click
- Next, Select Solid Fill
- Finally, Choose your favorite color

3. The Section Is Missing?

- If you're found missing section after
- Please "SEND TO BACK THE IMAGE" Click Back. It will be put placeholder image at section will showing up.

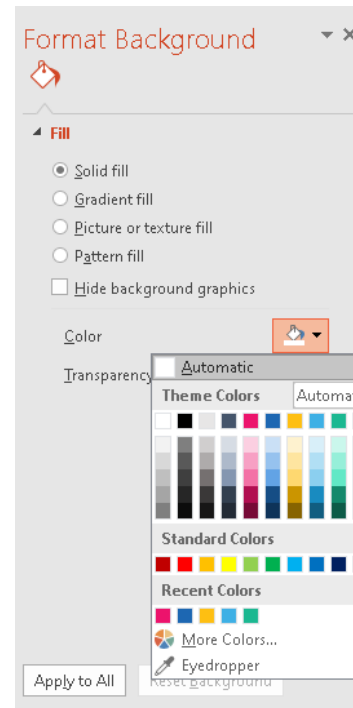
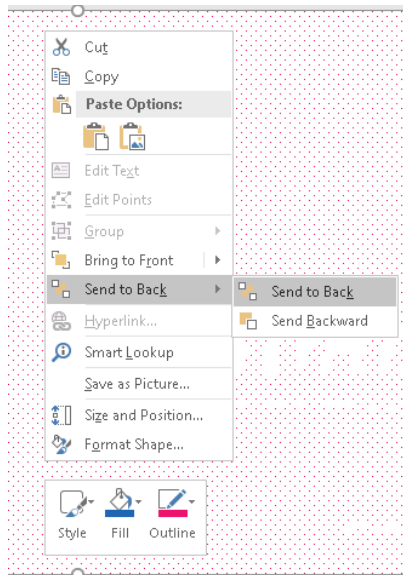

color (check in master slide or home)
"Paint Icon" > click "fill"

ADDING AN IMAGE PLACEHOLDER
The Are > Right Click> Click Send To
very bottom layer, and the missing

4. How To Install The Fonts

- Step 1, Download the fonts (URL(s) are included in **README.tx(t)**)
- Step 2, Copy Fonts in to **C:\Windows\Font**

THANK'S YOU